

DISCOVERY WHARF

A VISION FOR
WABAMUN REDEVELOPMENT



WABAMUN

THE VILLAGE ON THE LAKE





DISCOVERY WHARF

The Opportunity

A major change to the Wabamun industry base is coming in 2010. Long range plans have been put in place that will ensure the future sustainability and vitality of the Village of Wabamun.

Wabamun is in an advantageous position for waterfront development, with excellent existing facilities, services, and growth potential combined with a significant development reserve fund. All environmental regulatory processes and government approvals are underway. Strong consideration has been given to the preservation, restoration, and enhancement of all environmental resources and natural habitats to ensure they flourish for future generations.



Countdown to Development	
Element	Timeframe
Obtain Land	Feb. - Nov. 2010
Transfer of License of Occupation	Feb. 2010 - Mar. 2011
Environmental Approvals	Dec. 2009 - June 2011
Area Structure Approvals	Mar. - Sept. 2010
Developer Guidelines	Aug. - Dec. 2010

The Vision

The Village of Wabamun is poised to become *the* lakeshore destination on the Yellowhead highway. It will have strong appeal to anyone considering living on a lakeshore with access to well established services and amenities. Widely known for its dynamic lakefront marina and family fun park, Wabamun will evoke a beautiful and memorable visual image.



The concept calls for well designed and comprehensively planned residential, commercial and recreational neighborhoods. The integrity of a sensitive waterfront community will be preserved, while emphasizing character, flexibility and the inherent cultural and social well-being of the Village of Wabamun. Welcome to Discovery Wharf!



Residential Development

Residential concepts include cozy cottage retreats, beachfront and terraced living, high-end single family housing, high-density condos, senior's buildings, contemporary apartment and condo housing incorporated above commercial buildings.



Commercial Development

Proposed commercial developments include commercial businesses such as grocery stores, restaurants, delis, hotels and resorts, sports rentals, and even a lake research and interpretive centre. Light marine related businesses such as marinas, private docks, boat launches and services will be a natural fit for Discovery Wharf.



Recreational Development

The Village of Wabamun will grow as an active and vibrant community. Highlighting these active areas will be a new public beach and expansion of the spray park.

Adding to the energy will be a fishing dock, a safe swimming area, a trout pond, enhancement of the existing marina and waterways, the creation of a new inland marina and additional public boat launch facilities.

New parks and public play areas as well as a multi-use trail system are part of the vision. These trails will connect the waterfront area, environmental reserve, beach, and commercial and parking areas.

Discovery Wharf will truly be a thriving and uniquely desirable investment and fun destination for generations to come.

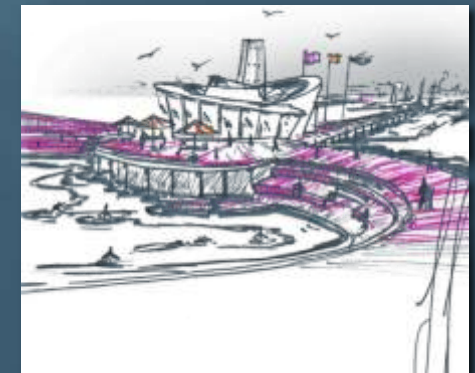

For more information visit

www.wabamun.ca